

REINFORCEMENT DETAILS OF 9.0M/400KG
PRESTRESSED CEMENT CONCRETE POLES (FACTOR OF SAFETY = 2.0)

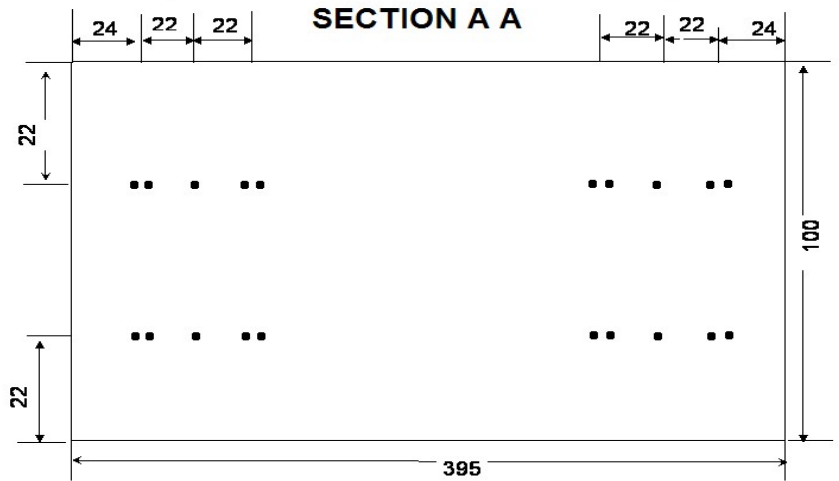
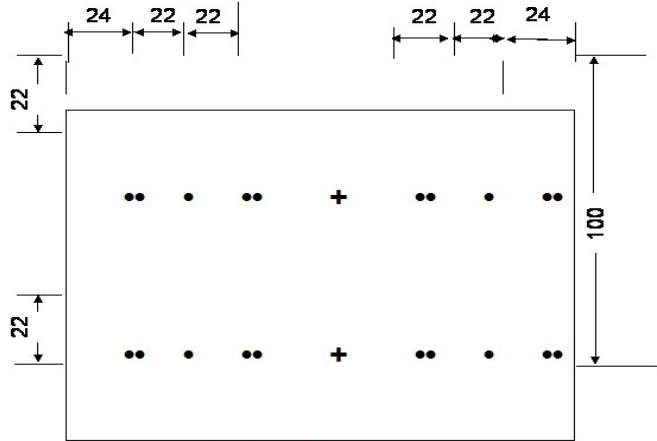
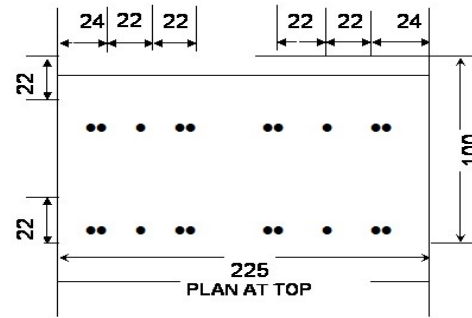
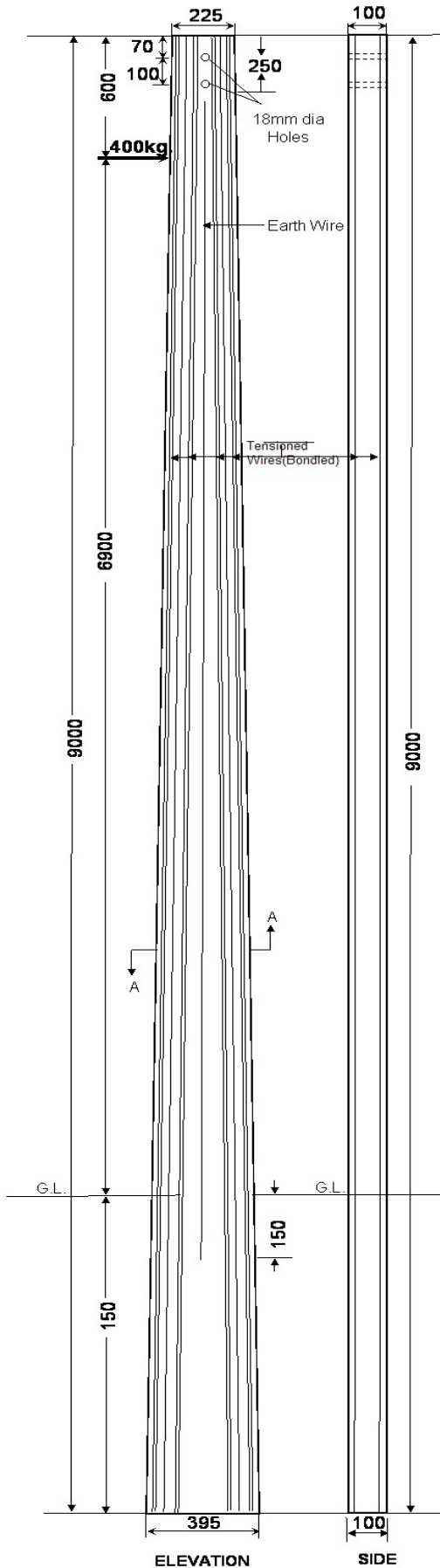

Location of holes as per REC Standards

- Denotes Tensioned Wire
- + Possible Position of Earth Wire

TECHNICAL GUARANTEE PARTICULARS OF 9.0mtr/400KG WORKING LOAD

SECTION: A) TOP	225X 100 MM
B) BOTTOM	395X 100 MM
QUANTITY OF CONCRETE	0.279M ³
CONCRETE GRADE	M-400
OVERALL LENGTH SUPPORT	9.0 MTR
PLANTING DEPTH	1.5 MTR
DIA METER OF PRESTRESSING WIRE	4 MM
NUMBER OF TENSIONED WIRE	20 NOS
PRE-TENSIONED APPLIED TO EACH 4MM WIRE	1760KGS
MINIMUM CUBE STRENGTH OF CONCRETE AT 28 DAYS	400 KG/CM ²
CLEAR COVER	20 MM
FACTOR OF SAFETY	2.0
WORKING LOAD	400 KGS
ULTIMATE LOAD	800 KGS
WEIGHT OF POLE (THEORITICAL)	697 KGS
LOAD APPLICATION AT A POINT FROM THE TOP	600 MM
ULTIMATE TENSION STRENGTH FOR 4MM WIRE	17500KG/CM ²